

Committee Members
David Reggiani, Chair
Robert Baty
Martin Moe
Jim Kacsh
Dick Groff
Mike Hicks
Tom Bailer

**CITY OF CORDOVA
PUBLIC SAFETY BUILDING DESIGN
COMMITTEE MEETING
FEBRUARY 8-9, 2011 @ 9:00 AM - 4:00 PM
THE LITTLE CHAPEL**

Deputy City Clerk
Robyn Kincaid

AGENDA

A. CALL TO ORDER

B. ROLL CALL

David Reggiani, Robert Baty, Martin Moe, Jim Kacsh, Dick Groff, Mike Hicks and Tom Bailer

C. APPROVAL OF AGENDA (voice vote)

D. AUDIENCE COMMENTS (3 min per speaker)

E. APPROVAL OF MINUTES - none (voice vote)

F. NEW & MISCELLANEOUS BUSINESS

Day 1 (February 8th)

- Introductions – PSBD Committee, A/E Team
- Workshop Objectives
- Project Schedule and Funding Sources
- Review of 2 Prospective Sites – compare advantages/disadvantages, rough costs
- Site Selection – Public Comment (3 min per speaker)
- Site Selection – Committee Comments
- Site Selection – Committee Motion (voice vote)

Break for Lunch

- PSBD Primary uses – starting point gross building area, functional components
- PSBD Functional Analysis
 - Interactive discussion of emergency response processes and work-flow, Police, Fire, 911 dispatch; public spaces
- Site Circulation
 - Interactive discussion of site access, emergency vehicles, parking, public use, snow storage
- PSBD Support Functions
 - Identify support and maintenance spaces of building users
- Audience Comments (3 min per speaker)
- Committee Comments

Day 2 (February 9th)

- Audience Comments (3 min per speaker)
- Functional Adjacencies Development
 - Site orientation, space planning diagrams, massing, (elevation/section?)
- Cost-Estimate Development
 - Discuss building systems (foundation, structure, building envelope materials)

Break for Lunch

- Emergency Services Break-out Sessions
 - Populate room Criteria sheets; police, fire, public spaces
- Summary Presentation

G. AUDIENCE COMMENTS

(3 min per speaker)

H. COMMITTEE COMMENTS**I. ADJOURNMENT**

**If you have a disability that makes it difficult to attend city-sponsored functions,
You may contact 424-6200 for assistance.**

All City Council agendas and packets available online at www.cityofcordova.net

CVFD PROPOSED FIRE FACILITIES

January 27, 2011

Background:

The City of Cordova stated in it's 2008 Comprehensive Plan, Chapter 4 Public Facilities and Services – Section B that a long term goal is “a new Public Safety Building located away from the flood zone” was crucial.

The City of Cordova Local Hazards Mitigation Plan has the Fire Department and Police Department listed as critical facilities that, “if damaged, could significantly impact public safety, economic conditions, and environmental integrity of Cordova.”

Cordova Volunteer Fire Department Master Plan presented to the Department on 10/08/09

The City Police and Fire Facilities Committee Report provides additional information

Fire Station Goals

Fire, rescue, haz-mat and EMS administration,
Fire training
Alternate Emergency Operations Center (EOC)
Response vehicle storage and routine equipment maintenance
OSHA compliant decontamination station
EMS training and response headquarters
Fire prevention and risk reduction through public education
Fire Explorers headquarters
Facilities and meeting rooms for department members and other community groups
May supplement Civic Center for conferences/meeting rooms for special events

Fire Department Requirements—Preliminary

Hose Tower—14' X 14'	196 sq. ft.
Possible entryway into building; foyer; rugged stairway for hose laying; top deck with repelling anchors; windows for ladder drills; confined-space tube	
Fire Chief's Office—10' X 14'	140
Fire Marshal's Office—10' X 14'	140.
Administrative Storage/Copy Room—11' X 26'	271
Files and records; office supplies; uniforms; T-shirt machine and equipment; public education materials; copy machine; fax machine; layout table for report preparation. This room to be divided into storage and copy/layout sections; coffee counter and cupboards	
Administrative Office—10' X 16'	160
This office used by paid FF and administrative assistant,.	
Staff Office—10' X 16'	160 sq. ft.
This office used by training, maintenance and safety officers; EMS Captain; Citizen Corps Council and volunteers doing staff work. Possible layout includes a bench type desk with three computer stations and accessories such as file cabinets, etc.	

Apparatus Bay—5 double deep bays, 15' wide by 90' long (82' X 90') 7,380
 Floor drains (spot or trench); steel rails in wheel tracks to prevent tire chain damage to the floor; ceiling height to allow tilting cab; 7" minimum floor thickness; support rooms along one sidewall with mezzanine over and direct access to the bay; bunker gear storage either in the bay or directly adjacent; janitors closet in close proximity; provide these utilities—electrical drop cords, air supply, water fill, and vehicle exhaust extraction system. At least one bay should be sized to accommodate an ARRF rig and an aerial device.

Note----The following support rooms require direct access to the apparatus bays

Workshop/Toolroom—16' X 16' 256
 File cabinet; shelves for apparatus manuals, etc.; tools; workbench; slop sink; air compressor here or in SCBA room; rated cabinet for flammables and paint; parts washer
 Laundry Deep, hands-free sink; (inc. slop sink and drying rack)—12' X 6' 72
 Extractor; washer; dryer; floor drain; ventilation; cupboard for cleaning solutions; racks for drying dive gear, ropes, tarps, etc. This room combined with medical cleanup/decontamination room.
 Medical Cleanup/Decontamination Room—12' X 10' 120
 Deep, hands-free sink; shower with hose supplies; (holding tank containment in drain line); bio hazard storage; tiled walls and floor; commercial water closet and lavatory (hands-free). This room combined with laundry.
 EMS Supply Room—12' X 16' 192
 Medical supplies; mannequins; white board; file cabinet; training props; cupboards and counters; computer station/desk for writing run reports
 Compressor, Bottle Storage, SCBA Maint.—10' X 16' 160
 Workbench; parts cabinet; three-phase power for compressor. Possibly include maintenance air compressor; (consider noise impact to adjacent spaces).
 Firematic Storage—14' X 16' 224
 Hose tools; appliances; spare stuff; spare hoses on racks; CERT locker; spare radios, batteries; pagers; radio charging banks; fit testing equipment; hose testing equipment; haz-mat supplies and equipment; fire training aids; and firefighting agent storage.
 Technical Rescue Locker—12' X 16' 192
 Technical rescue gear; SAR equipment; rope drying rack; dive suit drying rack; (ventilation required as well as floor drain);
 Janitor Closet ----Possibly built into another room or a bump-out 16
 Bunker Gear Lockers—16' X 20' 320
 Another option is store on rolling grid racks on apparatus bay floor between the apparatus

Storage Mezzanine ----

Spare tires; tire chains; seasonal decorations; extra bunker gear storage etc. This mezzanine could cover the entire area over the rooms listed above that require direct access to the apparatus bays.

Mechanical Spaces:	
Boiler Room—10' X 20'	200 sq ft
Electrical Switch Gear—6' X 12'	72
Water Service—2' X 8'	16
Emergency Generator—10' X 20'	200
Vertical Movement:	
Stairways—2 @ 8' X 20' each	320
Elevator—7' X 9'	63
Elevator Machine Room—6' X 8'	48
Entry Vestibule, Lobby, Reception	200
Janitors Closets (one each floor @ 16 sq ft)	32
Drinking Fountains (one each floor @ 6 sq ft)	12
Toilet Facilities ADA Compliant	
Men's (one each floor @ 100 sq ft)	200
Women's (one each floor @ 128 sq ft)	256
Conference Room/Library—16' X 20'	320
Provides for a large conference table (seat 10); bookshelves all around; Fire dept. library	
Fitness Room—16' 20'	320
Includes physical fitness equipment and mats for stretching, etc.	
Locker Room (Male)—12' X 14'	168
Lockers, showers, sink toilet, urinals	
Locker Room Female—12' X 14'	168
Lockers, showers, sink, toilets	
Training Room—24' X 42	1,008
Lounge/Day Room—16' X 20'	320
Conference Room (16 sq ft per person @ 100)	1600
Divided by folding wall with direct access to store room and kitchen	
Conference Room Storage—12' X 16'	192
A place to store tables and chairs, white boards, easles, decorations, table cloths, etc.	
Kitchen—16' X 24'	384
All equipment to be rated "light commercial" as a minimum	
Pantry/Storage—8' X 12'	96
Dorm/Bunk Rooms 12' X 14' three @ 168 sq. ft.)	504
Fire Department Net Requirements	16,525 sq. ft.
Fire Department Gross Requirements (Net X 1.15)	19,004 sq. ft.

Police and Fire Shared Spaces—Preliminary

Mechanical Spaces:

Boiler Room—10' X 20'	200 sq ft
Electrical Switch Gear—6' X 12'	72
Water Service—2' X 8'	16
Emergency Generator—10' X 20'	200

Vertical Movement:

Stairways—2 @ 8' X 20' each	320
Elevator—7' X 9'	63
Elevator Machine Room—6' X 8'	48

Dispatch Center

Two Station Console, radios, computer equipment, maps, printer, shredder, work table, book shelves—16' X 12'	192
Toilet and Kitchenette—12' X 10'	120
Dispatch Supervisors Office—12' X 12'	144
Filing/Storage Room—10' X 10'	100
6 file cabinets; 2 bookshelves	
Copy area—10' X 10'	100
Copy machine, table, cabinet	
Server Room/ Radio room—10' X 12'	120
Entry Vestibule, Lobby, Reception	200
Janitors Closets (one each floor @ 16 sq ft)	32
Drinking Fountains (one each floor @ 6 sq ft)	12
Toilet Facilities ADA Compliant	

Men's (one each floor @ 100 sq ft	200
Women's (one each floor @ 128 sq ft)	256
Conference Room/Library—16' X 20'	320
Large conference table (seat 10); bookshelves all around. Fire and law library	
Fitness Room—16' X 40'	640
Physical fitness equipment. Mats for defensive tactics. stretching, etc.	
Locker Room (Male)—20' X 30'	600
Lockers, showers, sink toilet, urinals	
Locker Room Female—20' X 30'	600
Lockers, showers, sink, toilet	
Driving Simulator Room—12' X 12'	144
Lounge/Day Room—25' X 30'	750
Training/Meeting Room (16 sq ft per person @ 100) Shared fire and police	1600
Divided by folding wall with direct access to store room and kitchen	
Conference Room Storage—12' X 16'	192
Store tables and chairs, white boards. training mats, props for firearms simulator	
Commercial Kitchen—16' X 24'	384 sq ft
Pantry/Storage—8' X 12'	96
Shared Space Net Requirements	7,721 sq ft
Shared Space Gross Requirements (net X 1.15)	8,879

Police Administration:

Chief 's Office w/ Meeting Space—12' X 24'	288
Administrative Assistant Office—12' X 12'	144
Office Supplies Storage—6' X 4'	24
Cleaning Closet/ storage—6' X 4'	24

Squadroom:

Officers Offices X 6—10' X 10' each	600
Adult Interview Room—8' X 10'	80
Child Soft Interview Room—10' X 14'	140
Equipment Storage Room—12' X 14'	168
Armory—10' X 10'	100
Supply Room—6' X 8'	48

Jail Facility:

Booking Area w/ one 8' X 10' Holding Cell—20' X 20'	400
Booking Computer; fingerprint computer, phone area	
DUI Processing Center inc. Datamaster—8' X 16'	128
Storage lockers for Jail—4' X 6'	32
Food Prep/Kitchenette with freezer and microwave—8' X 10'	80
Jail Supply Linen, toiletry, and prisoner uniform storage area 8' X 10'	80
Two Male Jail Cells with Dayroom	680
One Female Jail with Dayroom	340
Juvenile Holding Facility—8' X 10'	80
Visiting Room—8' X 8'	64

Sally Port—16' X 24'	384
----------------------	-----

Evidence Processing:

Evidence Processing Area—10' X 10'	100
------------------------------------	-----

Cabinetry; table; small drying cabinet

Evidence Store Room—16' X 16'	144
-------------------------------	-----

Two-foot shelves all the way around the room plus two rows down the middle

Parking outside storage:

Parking Garage for small equipment 12' X 24'	288
--	-----

Outside Evidence Storage for Bikes, etc.	120
--	-----

Property Storage for lubes, lights, traffic cones, etc. 10 X 12

Indoor Parking for five full size vehicles 10 x 24	1200
--	------

DMV:

Work Area—20' X 20'	400
---------------------	-----

Two desks; 8 file cabinets; computer

Office—10' X 10'	100
------------------	-----

Desk; office furniture

Police Department Specific Net Requirements	6236
---	------

Police Department Specific Gross Requirements (net X 1.15)	7171
--	------

Robyn Kincaid

From: Susan Bourgeois
Sent: Monday, January 31, 2011 3:51 PM
To: David Reggiani; James Kacsh; Martin Moe; Mike Hicks ; Richard Groff; Robert Baty; Robyn Kincaid; Tom Bailer
Subject: FW: Public Safety Building
Attachments: Cloward, Marc D (DPS).vcf

Susan Bourgeois, City Clerk
City of Cordova
PO Box 1210
Cordova, AK 99574
(907) 424-6248

From: Robert Baty
Sent: Monday, January 31, 2011 3:03 PM
To: Lila Koplin (cityclerk@cityofcordova.net)
Subject: FW: Public Safety Building

Susan,

Can you send this to the other Public Safety committee members.

Chief Robert Baty
Cordova Police Department
(907)424-6100
(907)424-6120
policechief@cityofcordova.net

From: Cloward, Marc D (DPS) [<mailto:marc.cloward@alaska.gov>]
Sent: Monday, January 31, 2011 2:39 PM
To: Robert Baty
Subject: Public Safety Building

Chief Baty, sorry for the delayed response to your inquiry about the Wildlife Troopers occupying space in the new Public Safety Building in Cordova.

I spoke with Lieutenant Godfrey regarding the matter. We both concluded, after some discussion, that the building concept and location will not facilitate our long-term plans here in Cordova.

We thank you for considering us in the proposal nonetheless.

Sgt. Marc Cloward
Alaska Wildlife Troopers
Cordova AK
907.424.3184

Snow Dump sites near proposed Public Safety Building

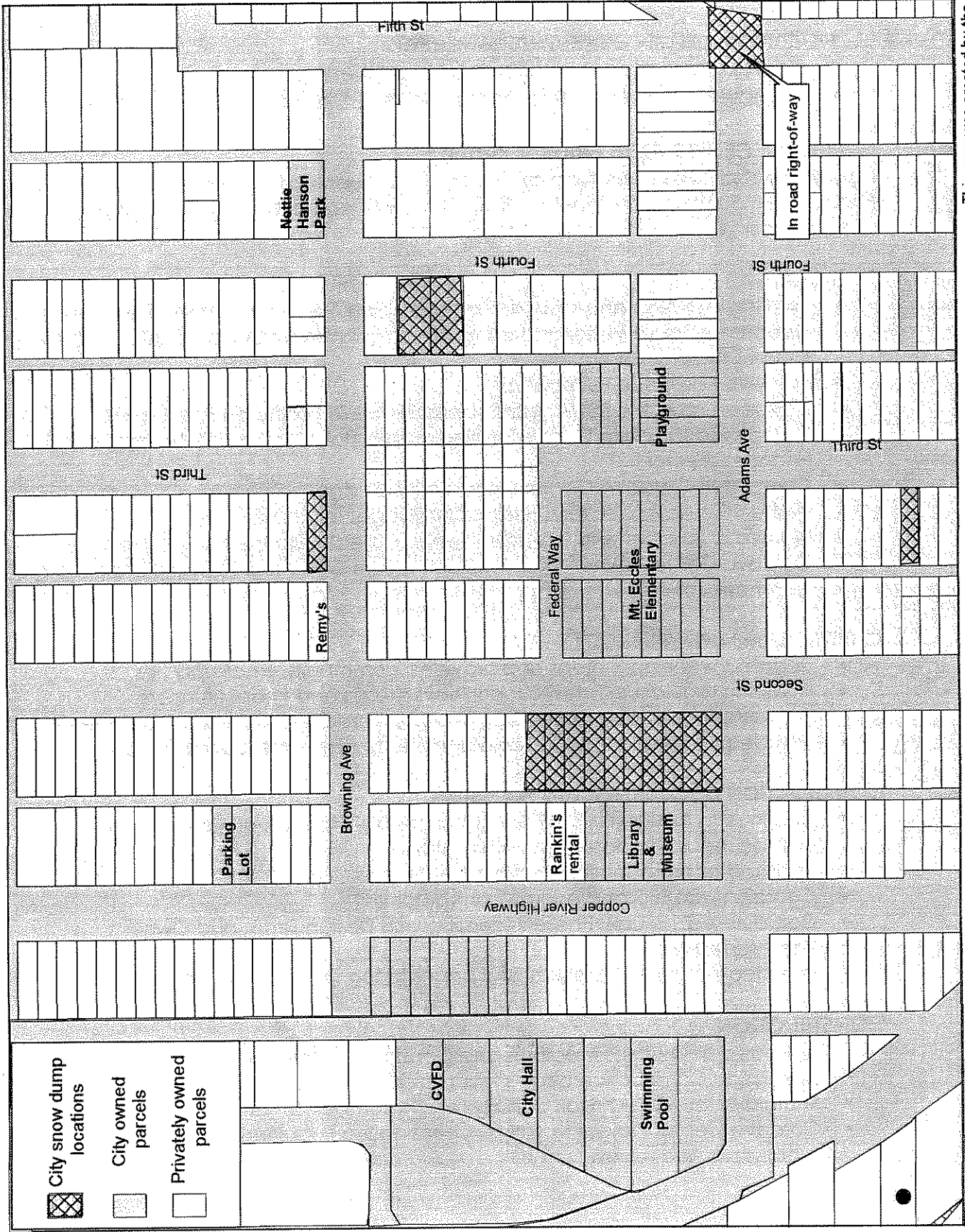

This map was created by the Planning Dept. for illustration purposes only. It is not intended to be used as a survey instrument.

This map was created by the City of Cordova Planning Dept on January 31st 2011. fwj

Proposed Public Safety Building location

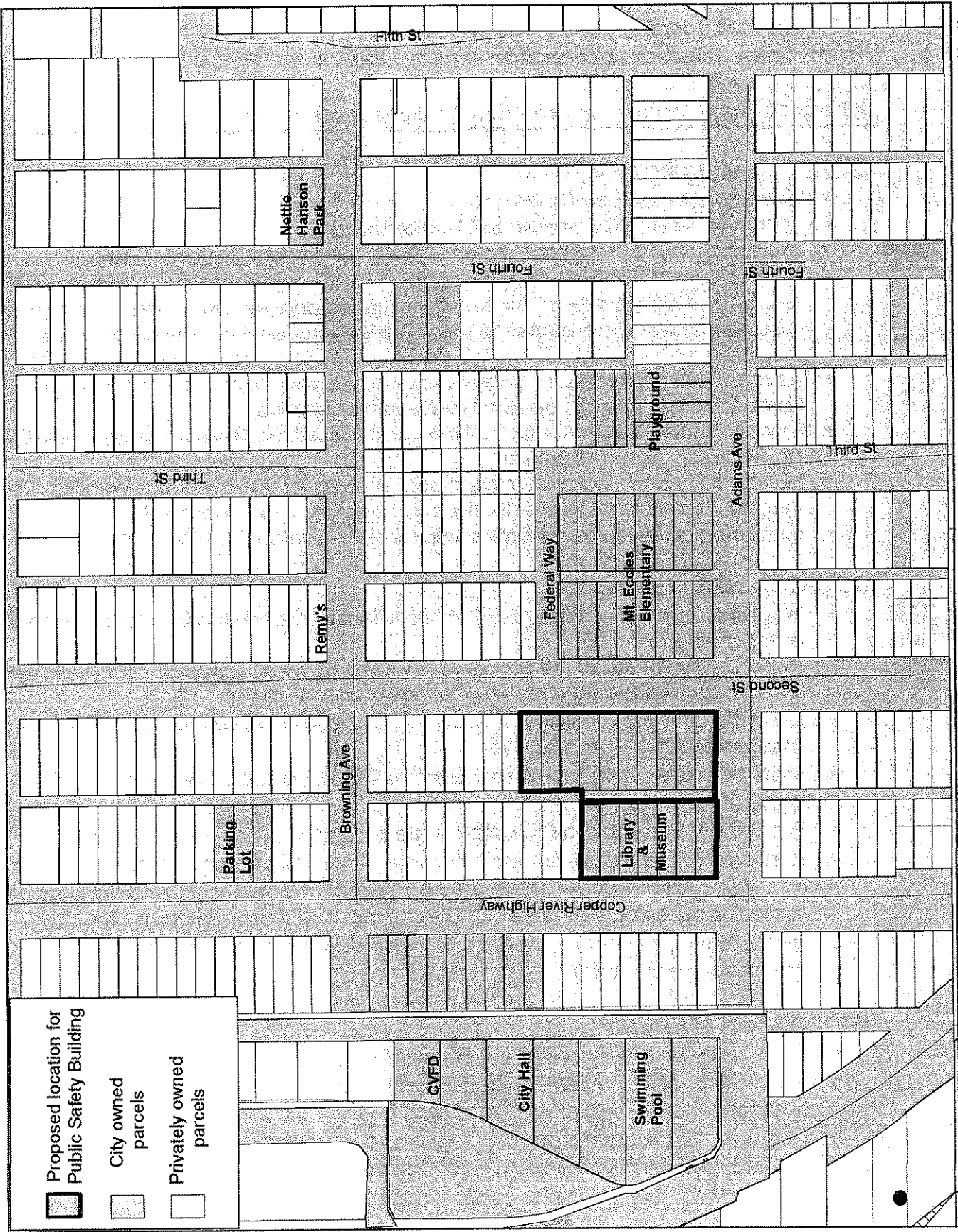

This map was created by the City of Cordova Planning Dept on January 31st 2011. fwj

This map was created by the Planning Dept. for illustration purposes only. It is not intended to be used as a survey instrument.

The map displays the Hospital Hill area in Everett, Washington. A legend in the bottom left corner identifies three types of areas: 'Proposed location for Public Safety Building' (thick black outline), 'City owned parcels' (light gray), and 'Privately owned parcels' (white). The map shows a grid of streets including Spruce St, Birch St, Alder Way, Young St, Eighth St, Fifth St, Fourth St, Third St, Second St, and First St. Key landmarks include Hospital Hill (a large light gray area), Odiak Slough (a dark gray area), and Everett Lake (a dark gray area). A callout points to a location on the eastern edge of the map, labeled 'Approximate location of cemetery'.

This map was created by the Planning Dept. for illustration purposes only. It is not intended to be used as a survey instrument.